

[crossways-offices.co.uk](http://crossways-offices.co.uk)



# LAKEVIEWWEST



CROSSWAYS BUSINESS PARK, DARTFORD DA2 6QE

**FULLY REFURBISHED OFFICES WITH LAKESIDE VIEWS**

**9,437 SQ FT TO LET**

# LAKEVIEW WEST

A thriving business park environment  
with excellent on-site and  
local amenities.



Lakeside Views

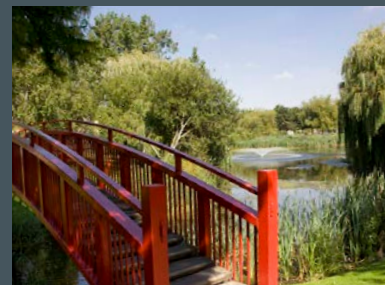

Crossways Business Park is an established mixed-use business park located on the outskirts of Dartford, in the heart of the Thames Gateway. The park which extends to over 300 acres, is home a number of national and international companies including Bellway Homes, Laing O'Rourke, Kuehne & Nagel, Mazda, Diebold Nixdorf and Handlesbanken to name but a few...so you'll be in good company!!

## Local amenities

Lakeview 360 Café
Costa Coffee
The Wharf Public House
Burger King
Asda Superstore & Filling Station
Holiday Inn Express
Campanile Hotel
Travelodge







Ground floor



Ground floor

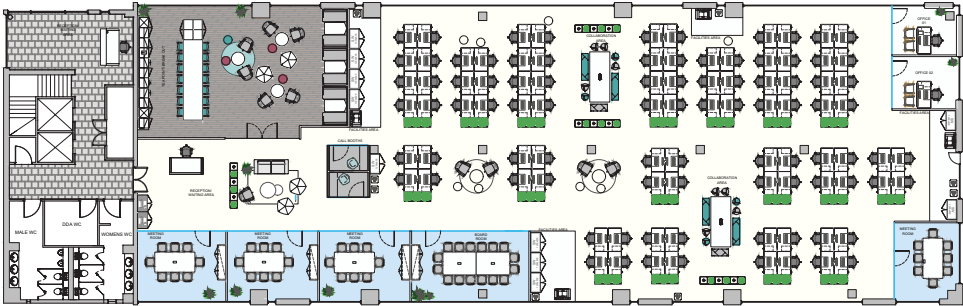

INDICATIVE SPACE PLAN



AIR CONDITIONING



FULL ACCESS  
RAISED FLOORS



METAL SUSPENDED  
CEILINGS



LED LIGHTING



PASSENGER LIFT



MALE, FEMALE &  
DISABLED WC'S



EXCELLENT PARKING  
RATIO OF 1:241 SQ FT



FULLY DDA COMPLIANT



FLOOR AREAS

Floor	sq ft	sq m
Ground	9,437	876
<b>Total</b>	<b>9,437</b>	<b>876</b>

The floor areas have been measured on an IPMS3 basis.



## LAKEVIEW WEST

CROSSWAYS BUSINESS PARK, DARTFORD DA2 6QE

A transport hub with fast connections both domestically and internationally.

Lakeview West is located on Crossways Business Park at junction 1a of the M25, close to the Dartford Crossing. The park benefits from excellent transport connectivity being close to Stone Crossing and Greenhithe stations, as well as having the fast track bus route linking Dartford town centre to Gravesend.

There are two railway stations, Greenhithe and Stone Crossing, on the Gillingham to London line (40 minutes to Central London). Ebbsfleet International Station is approximately 3 miles to the east (17 minutes to Central London).

